

Product **Polzahl: 5, Einbaudose für Leiterplattenmontage, gewinkelt, mit Schirmblech, mit UL-Zulassung**  
 Area **M12-A Series 713/763**  
 Article number **99 3442 601 05**

Illustration	Scale drawing	Contact Arrangement																		
	<p>Leiterplattendicke: 1,6 mm 4-pol. ohne Kontakt 5</p>	<table border="1" style="margin: 10px auto;"> <thead> <tr> <th></th> <th>X</th> <th>Y</th> </tr> </thead> <tbody> <tr> <td>1</td> <td>-2,50</td> <td>0,00</td> </tr> <tr> <td>2</td> <td>0,00</td> <td>2,50</td> </tr> <tr> <td>3</td> <td>2,50</td> <td>0,00</td> </tr> <tr> <td>4</td> <td>0,00</td> <td>-2,50</td> </tr> <tr> <td>5</td> <td>0,00</td> <td>0,00</td> </tr> </tbody> </table> <p style="font-size: small;">Geschirmte Versionen: Schirm auf Gehäuse Shielded versions: shield on housing</p>		X	Y	1	-2,50	0,00	2	0,00	2,50	3	2,50	0,00	4	0,00	-2,50	5	0,00	0,00
	X	Y																		
1	-2,50	0,00																		
2	0,00	2,50																		
3	2,50	0,00																		
4	0,00	-2,50																		
5	0,00	0,00																		

You can find the assembly instruction on the next page.

## Technical data

### General features

Connector Design	integrated socket
Connector locking system	bolted
Termination	dip-solder
Upper temperature	85 °C
Lower temperature	-40 °C

### Cable data

Approval 1	UL
------------	----

### Electrical parameters

Rated voltage	125 V
Rated impulse voltage	1500 V
Pollution degree	3
Overvoltage category	II
Material group	III
Rated current (40°C)	4 A
Volume resistivity	≤ 3 mΩ
EMV compliance	shielded
Degree of protection	IP68
Mechanical operation	> 50 Mating cycles

### Material

Material of contact	CuSn (Bronze)
Contact plating	Au (gold)
Material of contact body	PA

Product **Polzahl: 5, Einbadose für Leiterplattenmontage, gewinkelt, mit Schirmblech, mit UL-Zulassung**  
Area **M12-A Series 713/763**  
Article number **99 3442 601 05**

Installation instructions / Mounting cutout

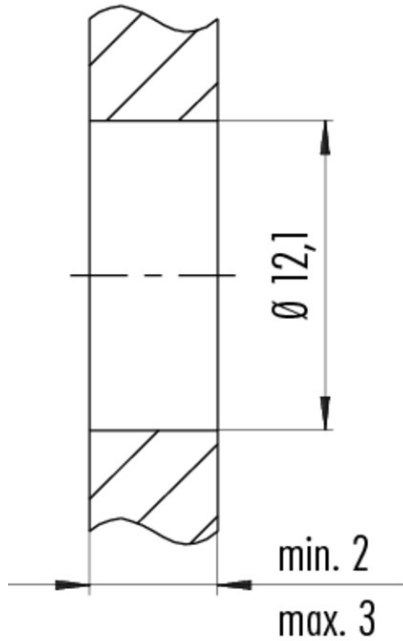

Anzugsdrehmoment / Tightening torque  
M12 x 1      6,25 Nm

Installation instructions / Mounting cutout

