

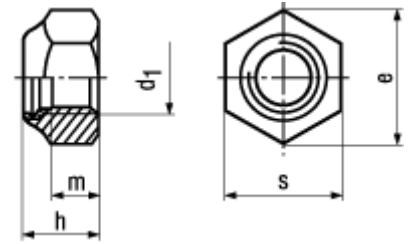

DIN 985  
Standard withdrawn

6

**BN 161****Prevailing torque type hex lock nuts**

thin type, with polyamide insert

Steel 6

zinc plated blue

- ~UNI 7474

**Article-No. - 1094939**

d <sub>1</sub>	M5
e min.	8,79
h max.	5
m	3,2
s	8