

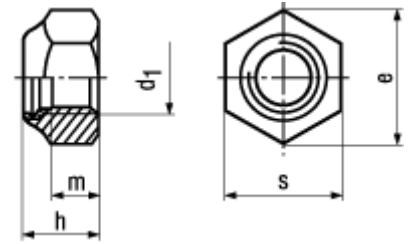

DIN 985  
Standard withdrawn

6



## BN 161

### Prevailing torque type hex lock nuts

thin type, with polyamide insert

Steel 6

zinc plated blue

- ~UNI 7474

 [Download product information](#)

#### Article-No. - 1444921

d <sub>1</sub>	M6
e min.	11,05
h max.	6
m	4
s	10