

Customer Information Sheet

IF IN DOUBT - ASK



NOT TO SCALE

THIRD ANGLE PROJECTION

ALL DIMENSIONS IN mm

SPECIFICATION:

MATERIAL:

CONTACT SHELL = BRASS

CONTACT CLIP = BERYLLIUM COPPER

FINISH (OVER NICKEL):

SEE ORDER CODE

FOR COMPLETE SPECIFICATION, SEE COMPONENT SPECIFICATION C006XX (LATEST ISSUE).

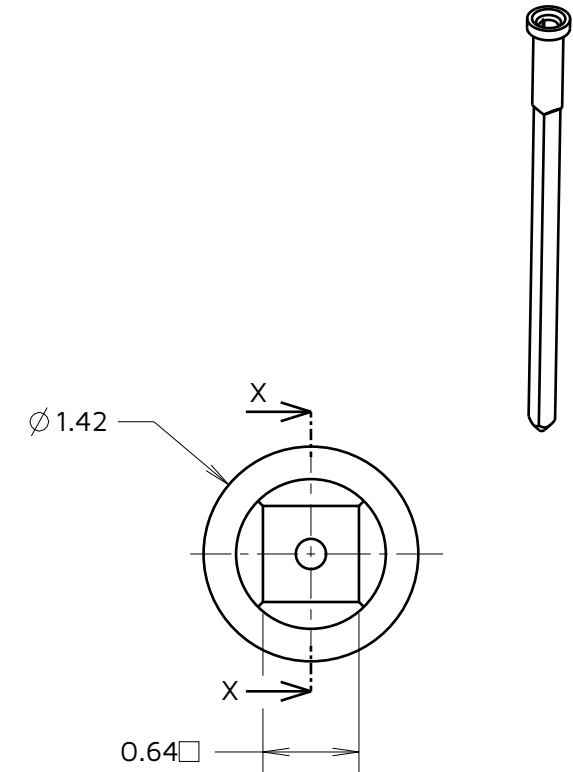
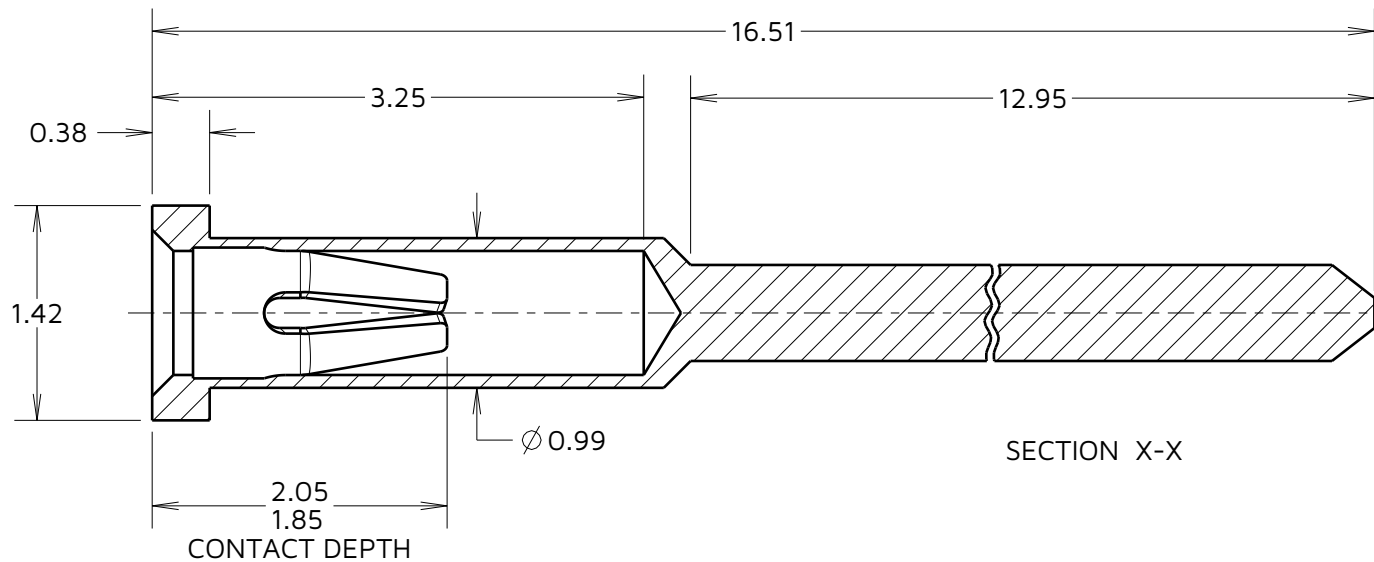

NOTES:

1. RECOMMENDED MOUNTING HOLE SIZE = $\phi 1.05 \pm 0.05$ mm
2. RECOMMENDED PIN SIZE = $\phi 0.41$ TO 0.53mm

ORDER CODE:

H3175-XX

FINISH:

01 = 100% TIN SHELL, GOLD CLIP

05 = GOLD SHELL, GOLD CLIP

46 = 100% TIN SHELL & 100% TIN CLIP

| | | | |
|----------------------|------|----------|-------|
| MJ | 9 | 23.08.24 | 34124 |
| NAME | ISS. | DATE | CN/CO |
| APPROVED: M. JELLEY | | | |
| CHECKED: R. PORTLOCK | | | |
| DRAWN: J.CLAY | | | |

HARWIN

www.harwin.com

TOLERANCES

X. = ± 1 mm
 X.X = ± 0.50 mm
 X.XX = ± 0.20 mm
 X.XXX = ± 0.01 mm

ANGLES = $\pm 5^\circ$
 UNLESS STATED

THIS DRAWING AND ANY INFORMATION OR DESCRIPTIVE MATTER SET OUT HEREON ARE CONFIDENTIAL AND COPYRIGHT PROPERTY OF THE HARWIN GROUP AND MUST NOT BE DISCLOSED, LOANED, COPIED OR USED FOR MANUFACTURING, TENDERING OR FOR ANY OTHER PURPOSE WITHOUT THEIR WRITTEN PERMISSION.

MATERIAL & FINISH:

SEE ABOVE

TITLE:

**SUB MINIATURE SOCKET ASSY
 WIRE WRAP (3 LEVEL)**

DRAWING NUMBER:

H3175-XX

SHT
 2
 OF 2