

Customer Information Sheet

DRAWING No. H3175-XX

SHEET 2 OF 2

IF IN DOUBT - ASK

©

NOT TO SCALE

THIRD ANGLE PROJECTION

ALL DIMENSIONS IN mm

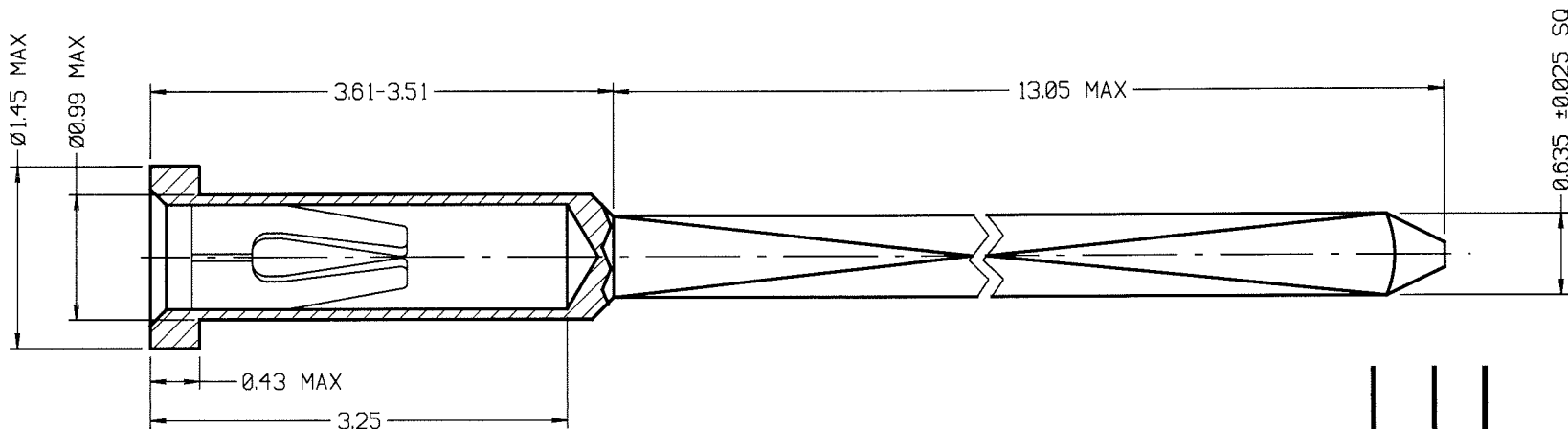

SPECIFICATION:

MATERIAL:

CONTACT SHELL - BRASS
CONTACT CLIP - BERYLLIUM COPPER

FINISH:

01 - 0.10µ GOLD CLIP, 4µ TIN SHELL
05 - 0.10µ GOLD CLIP, 0.13µ GOLD SHELL
46 - 1.3µ 100% TIN CLIP, 4µ TIN SHELL

ELECTRICAL:

CURRENT RATING - 2 AMPS MAX
CONTACT RESISTANCE (INITIAL) - 10 MILLIOHMS MAX

MECHANICAL:

INSERTION FORCE (0.5mm GAUGE) - 6N MAX
WITHDRAWAL FORCE (0.5mm GAUGE) - 0.5N MIN
DURABILITY - 01, 05 - 500 OPERATIONS
46 - 50 OPERATIONS

ENVIRONMENTAL:

OPERATING TEMPERATURE - -55°C TO +100°C
FOR COMPLETE SPECIFICATION, SEE COMPONENT SPECIFICATION C006XX (LATEST ISSUE).

NOTES:

1. RECOMMENDED HOLE SIZE = 0.110/1.00mm.
2. MAXIMUM CONTACT DEPTH = 2.16mm.
3. MAXIMUM PIN LENGTH = 3.15mm.
4. RECOMMENDED PIN DIAMETER = 0.53-0.41mm.

ORDER CODE:

H3175-XX

FINISH:

- 01 = GOLD CLIP, TIN SHELL
- 05 = GOLD CLIP, GOLD SHELL
- 46 = 100% TIN CLIP & TIN SHELL

JMB 6 12.07.05 8627

NAME	ISS.	DATE	C/NOTE

APPROVED: *[Signature]*

CHECKED: *[Signature]*

DRAWN: J CLAY

CUSTOMER REF.:

ASSEMBLY DRG:

HARWIN

THIS DRAWING AND ANY INFORMATION OR DESCRIPTIVE MATTER SET OUT HEREON ARE CONFIDENTIAL AND COPYRIGHT PROPERTY OF THE HARWIN GROUP AND MUST NOT BE DISCLOSED, LOANED, COPIED OR USED FOR MANUFACTURING, TENDERING OR FOR ANY OTHER PURPOSE WITHOUT THEIR WRITTEN PERMISSION.

TOLERANCES

X. - ±1mm
X.X - ±0.25mm
X.XX - ±0.10mm
X.XXX - ±0.01mm
ANGLES = ±5°
UNLESS STATED

MATERIAL:

SEE ABOVE

FINISH: SEE ABOVE

S/AREA: mm²

TITLE:

SUB MINIATURE SOCKET ASSY
WIRE WRAP (3 LEVEL)

DRAWING NUMBER:

H3175-XX

HARWIN USA
TEL: 603 893 5376
FAX: 603 893 5396
mis@harwin.com

HARWIN Europe (UK)
TEL: 023 9231 4545
FAX: 023 9231 4590
mis@harwin.co.uk

HARWIN Asia
TEL: +65 6 779 4909
FAX: +65 6 779 3868
mis@harwin.com.sg

SHT
2
OF
2