

Customer Information Sheet

DRAWING No.: H3175-XX

SHEET 2 OF 2

IF IN DOUBT - ASK

©

NOT TO SCALE

THIRD ANGLE PROJECTION

ALL DIMENSIONS IN mm

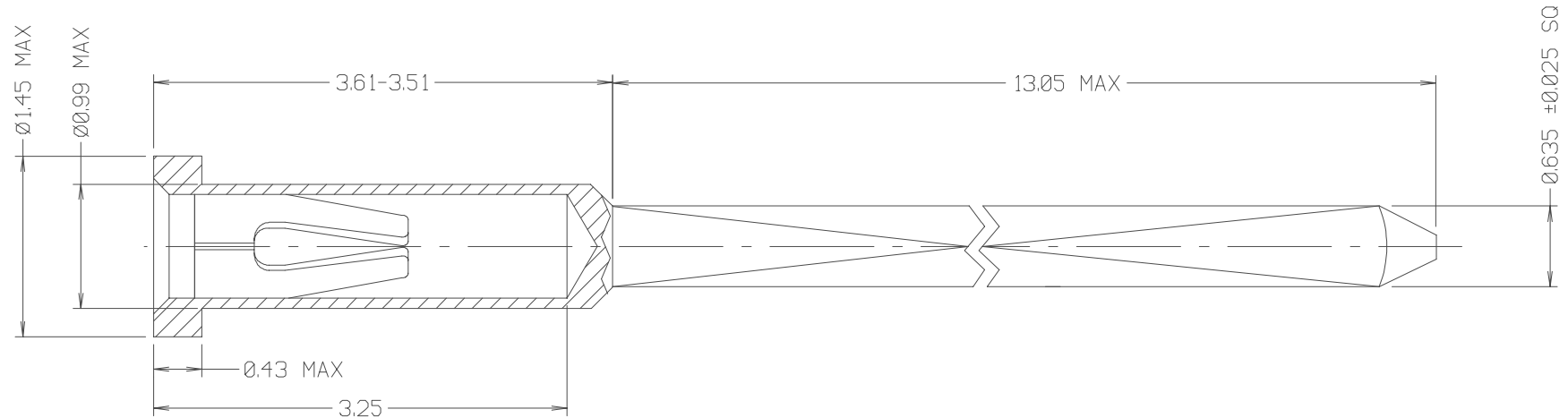

SPECIFICATION:

MATERIAL:

CONTACT SHELL = BRASS
CONTACT CLIP = BERYLLIUM COPPER

FINISH:

Ø1 = 0.10µ GOLD CLIP, 4µ TIN SHELL
Ø5 = 0.10µ GOLD CLIP, 0.13µ GOLD SHELL
T6 = 1.3µ 90/10 TIN/LEAD CLIP, 4µ TIN SHELL

ELECTRICAL:

CURRENT RATING = 2 AMPS MAX
CONTACT RESISTANCE (INITIAL) = 10 MILLIOHMS MAX

MECHANICAL:

INSERTION FORCE (Ø0.5mm GAUGE) = 6N MAX
WITHDRAWAL FORCE (Ø0.5mm GAUGE) = Ø0.5N MIN
DURABILITY = Ø1, Ø5 = 500 OPERATIONS
T6 = 50 OPERATIONS

ENVIRONMENTAL:

OPERATING TEMPERATURE = -55°C TO +100°C
FOR COMPLETE SPECIFICATION, SEE COMPONENT SPECIFICATION C006XX (LATEST ISSUE).

NOTES:

1. RECOMMENDED HOLE SIZE = Ø1.10/1.00mm.
2. MAXIMUM CONTACT DEPTH = 2.16mm.
3. MAXIMUM PIN LENGTH = 3.15mm.
4. RECOMMENDED PIN DIAMETER = Ø0.53-0.41mm.

ORDER CODE:

H3175-XX

FINISH:

Ø1 = GOLD CLIP, TIN SHELL
Ø5 = GOLD CLIP, GOLD SHELL
T6 = 90/10 TIN/LEAD CLIP, TIN SHELL

5	29.11.00	5611
ISS.	DATE	C/NOTE
APPROVED:		
CHECKED:		
DRAWN: J. KEIR		
CUSTOMER REF.:		
ASSEMBLY DRG:		



THIS DRAWING AND ANY INFORMATION OR DESCRIPTIVE MATTER SET OUT HEREON ARE CONFIDENTIAL AND COPYRIGHT PROPERTY OF THE HARWIN GROUP AND MUST NOT BE DISCLOSED, LOANED, COPIED OR USED FOR MANUFACTURING, TENDERING OR FOR ANY OTHER PURPOSE WITHOUT THEIR WRITTEN PERMISSION.

TOLERANCES
X. = ±1mm
X.X = ±0.25mm
X.XX = ±0.10mm
X.XXX = ±0.01mm
ANGLES = ±1°
UNLESS STATED

MATERIAL:

SEE ABOVE

FINISH: SEE ABOVE

S/AREA:

mm²

TITLE:

SUB MINIATURE SOCKET ASSY
WIRE WRAP (3 LEVEL)

DRAWING NUMBER:

H3175-XX

HARWIN INC
U.S.A.
TEL: (812) 285 0055
FAX: (812) 285 0056

HARWIN PLC
U.K.
TEL: 023 9231 4545
FAX: 023 9231 4590

HARWIN PTE
SINGAPORE
TEL: 65 7794909
FAX: 65 7793868

SHT
2
OF
2