

CUSTOMER P/N: 1884054-0.6

REVISIONS		
REV	DESCRIPTION	DATE
A	INITIAL SAMPLE	NOV.29.18
B	CHANGE THICKNESS	APR.09.19
C	CHANGE OVERLAY ARTWORK	DEC.25.19
D	CHANGE OVERLAY ARTWORK	FEB.06.20
E	CHANGE OVERLAY ARTWORK	JUN.15.20
F	CHANGE OVERLAY ARTWORK	APR.25.25

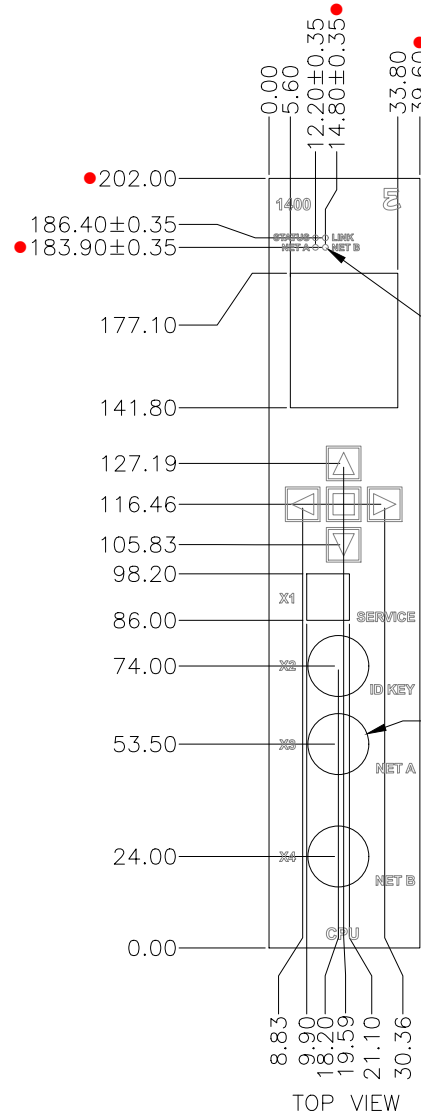

TOP VIEW

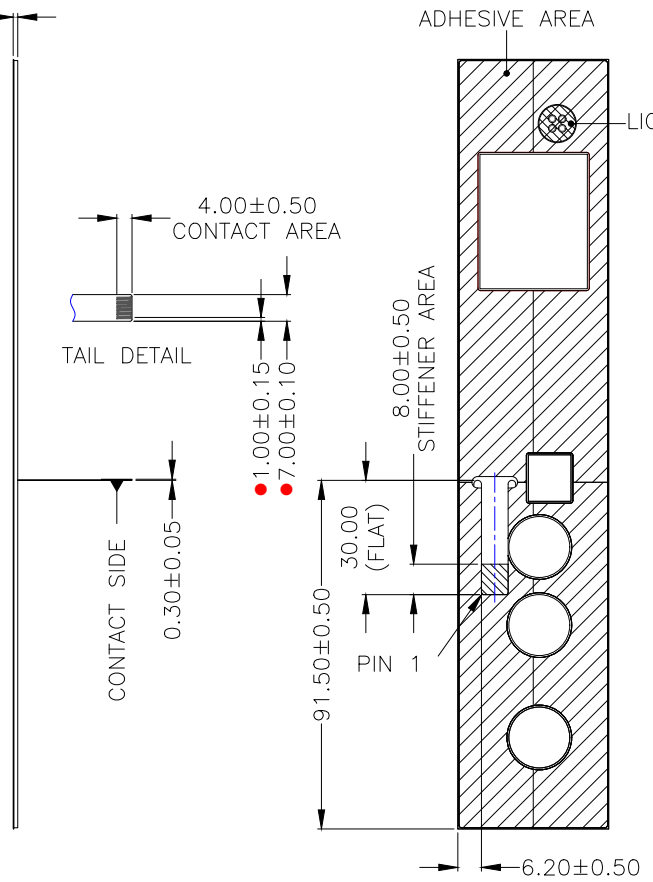

BACK VIEW

This drawing reflects Printec's interpretation of any and all information given. Tooling cannot begin until this drawing has been signed and returned to Printec.

Customer Approval Signature _____ Date _____

UNLESS OTHERWISE SPECIFIED DIMENSIONS ARE IN MM (INCHES).
 TOL ON ANGLE ±1/2°
 METRIC IMPERIAL
 .X= ±.35 .XX= ± .014"
 .XX= ±.25 .XXX= ± .010"

● INDICATES CRITICAL DIMENSION OR ITEM BE INSPECTED.

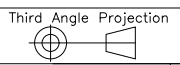

CONFIDENTIAL	
<small>THIS INFORMATION, DRAWING, SPECIFICATION, AND DATA IS PROPRIETARY AND CONFIDENTIAL INFORMATION MAY NOT BE DISCLOSED, REPRODUCED, OR USED, EITHER IN PART OR IN WHOLE, FOR THE BENEFIT OF ANY THIRD PARTY WITHOUT THE EXPRESS WRITTEN CONSENT OF PRINTEC CORPORATION</small>	
Drn: TOM	2025/04/25
Chk:	
App: JOHNNY	2025/04/25
TRACKING: 031738	
FILE NAME: M-995-01F.dwg	

PRINTEC Printec H.T. Electronics Corp.
<http://www.printecht.com>
 Tel: +886-2-82277899 Fax: +886-2-82275909

Title: MEMBRANE SWITCH		
Size: D	DOC. P/N: A-0995-0001-000	Rev: F
Scale: free	Sheet 1 of 4	

Structure/結構

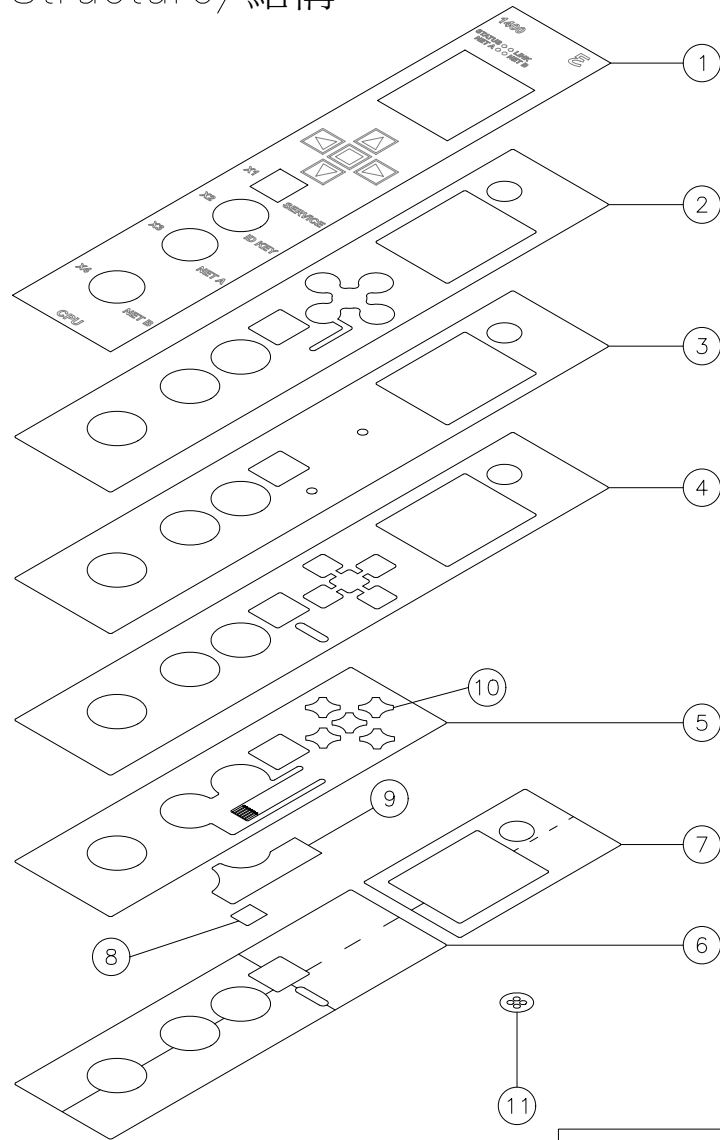

Bill of Materials/材質

零件規格 (STRUCTURE)		ADH(X) : S-SINGLE SIDE ADHESIVE ; D-DOUBLE SIDE ADHESIVE			
NO.	NAME	MATERIAL	THICKNESS/SIZE (mm)	REMARK	
1	OVERLAY 面板	PET	0.15	TEXTURED	AUTOTEX F150
2	OVERLAY ADHESIVE 面板背膠	ADH(D)	0.18	3M467	3M7957
3	DOME COVERLAY 彈片覆蓋層	PET	0.05	LUMIRROR	LUMIRROR / 0.05
4	DOME SPACER 間片	ADH(D)	0.28	3M467	3M7961
5	CIRCUIT 線路	PET	0.125	LUMIRROR	LUMIRROR / 0.125
6	REAR ADHESIVE 背膠	ADH(D)	0.107	ADH(D)	PO1TB+3M467
7	SHIELD ADHESIVE SHIELD ADHESIVE	ADH(D)	0.16	PI W/ 1-SIDE ADHESIVE	PET/0.05+銅箔膠/0.055+3M9703
8	STIFFENER 補強板	ADH(S)	0.175	PET W/ 1-SIDE ADHESIVE	PT-5S
9	FILLER 貼頭	PET	0.125	SW83G	SW83G / 0.125
10	METAL DOME 彈片	SS	0.70 h / ϕ 10	NI-PLATED	NICOMATIC N10-4L-340-21
11	LIGHT STOPPER 遮光圈	ADH(D)	0.64	PET W/ 2-SIDE ADHESIVE	3M5925
TOTAL THICKNESS (REF.1-2-3-4-5-6) :			0.892±0.10		

Specifications/規格&特性

成品規格 (SPECIFICATION)	
ITEM	SPECIFICATION
1 CONTACT RESISTANCE	200 Ω MAX.
2 INSULATION RESISTANCE	100 M Ω MIN.
3 ELECTRICAL ENDURANCE	500,000 MIN.
4 CONTACT RATING	20mA / 30VDC
5 DIELECTRIC STRENGTH	250 VDC MAX.
6 CONTACT BOUNCE	10m SEC. MAX.
7 MOISTURE PROOF	40°C 90~95% 72H
8 OPERATING TEMPERATURE	-20°C ~ +65°C
9 STORAGE TEMPERATURE	-30°C ~ +75°C

This drawing reflects Printec's interpretation of any and all information given. Tooling cannot begin until this drawing has been signed and returned to Printec.

Customer Approval Signature _____ Date _____

Third Angle Projection

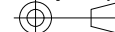

CONFIDENTIAL

THIS INFORMATION, DRAWING, SPECIFICATION, AND DATA IS PROPRIETARY AND CONFIDENTIAL. INFORMATION MAY NOT BE DISCLOSED, REPRODUCED, OR USED, EITHER IN PART OR IN WHOLE, FOR THE BENEFIT OF ANY THIRD PARTY WITHOUT THE EXPRESS WRITTEN CONSENT OF PRINTEC CORPORATION.

Drn: TOM 2025/04/25

Chk:

App: JOHNNY 2025/04/25

TRACKING: 031738

FILE NAME: M-995-01F.dwg

PRINTEC Printec H.T. Electronics Corp.
http://www.printecht.com
Tel: +886-2-82277899 Fax: +886-2-82275909

DOC.P/N:

A-0995-0001-000F

Scale: free Sheet 2 of 4

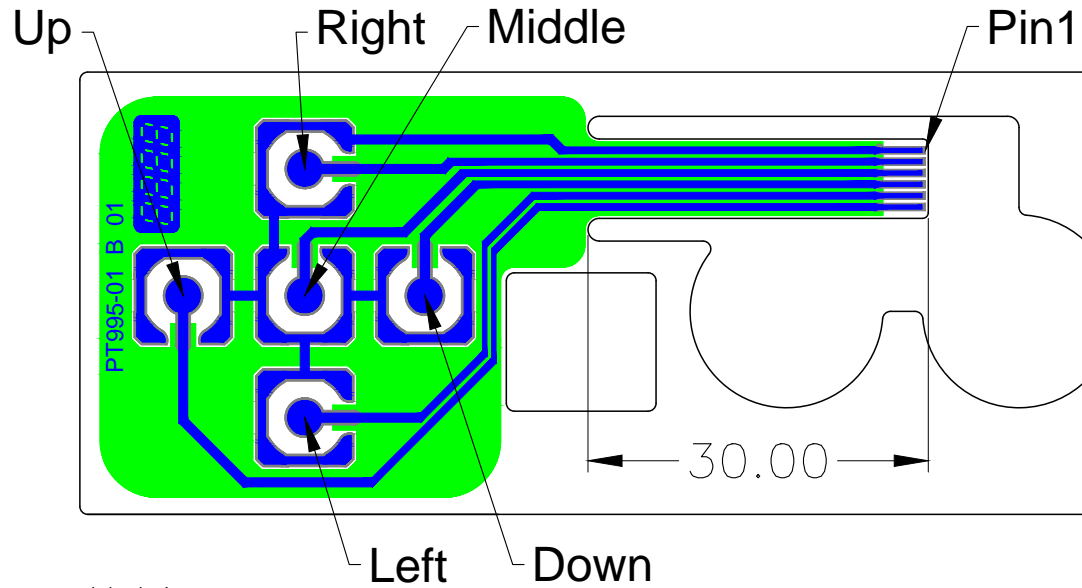

Matrix:

- Pin1 -> GND
- Pin2 -> Right Button
- Pin3 -> Middle Button
- Pin4 -> Down Button
- Pin5 -> Left Button
- Pin6 -> Up Button



Silver



Carbon



Dielectric

This drawing reflects Printec's interpretation of any and all information given. Tooling cannot begin until this drawing has been signed and returned to Printec.

Customer Approval Signature

Date

UNLESS OTHERWISE SPECIFIED DIMENSIONS ARE IN MM [INCHES] TOL ON ANGLE ±1/2°
 METRIC IMPERIAL
 .X= ±.35 .XX= ± .014"
 .XX= ±.25 .XXX= ± .010"

● INDICATES CRITICAL DIMENSION OR ITEM BE INSPECTED.

Third Angle Projection

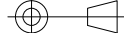

CONFIDENTIAL

THIS INFORMATION, DRAWING, SPECIFICATION, AND DATA IS PROPRIETARY AND CONFIDENTIAL INFORMATION MAY NOT BE DISCLOSED, REPRODUCED, OR USED, EITHER IN PART OR IN WHOLE, FOR THE BENEFIT OF ANY THIRD PARTY WITHOUT THE EXPRESS WRITTEN CONSENT OF PRINTEC CORPORATION.

Drn: CHIAWEI 2025/04/28
 Chk: TOM 2025/04/28
 App: JOHNNY 2025/04/28

TRACKING: 031738
 FILE NAME: L-995-01F.dwg



Printec H.T. Electronics Corp.
<http://www.printech.com>
 Tel: +886-2-82277899 Fax: +886-2-82275909

Title:

CIRCUIT LAYOUT

Size: D

DOC. P/N: A-0995-0001-000

Rev: F

Scale: free Sheet 3 of 4

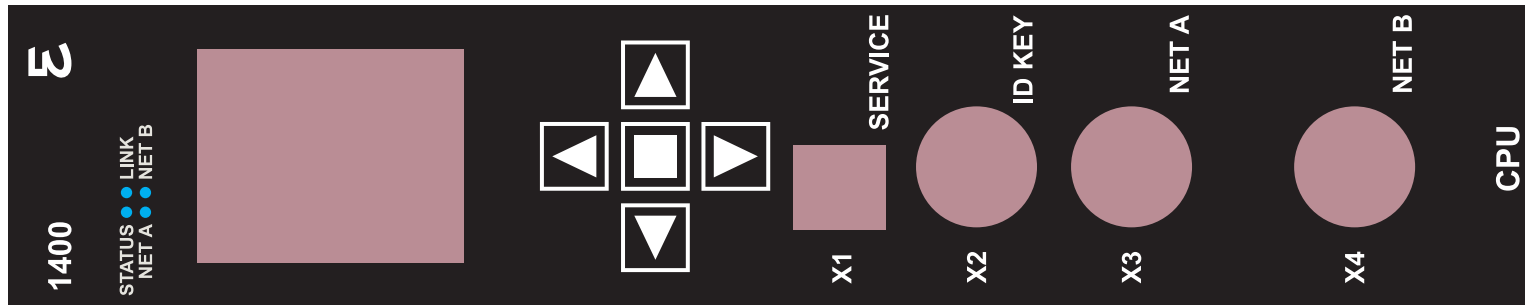

- Black / RAL 9017
- LED Transparent window
- White / RAL 9003
- Cut Out

NOTE: COLOR / SPEC.NO.

This drawing reflects Printec's interpretation of any and all information given. Tooling cannot begin until this drawing has been signed and returned to Printec.

Customer Approval Signature Date

UNLESS OTHERWISE SPECIFIED DIMENSIONS ARE IN MM [INCHES] TOL ON ANGLE ±1/2°
METRIC IMPERIAL
.X = ±.35 .XX = ± .014"
.XX = ±.25 .XXX = ± .010"

● INDICATES CRITICAL DIMENSION OR ITEM BE INSPECTED.

Third Angle Projection

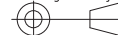

CONFIDENTIAL

THIS INFORMATION, DRAWING, SPECIFICATION, AND DATA IS PROPRIETARY AND CONFIDENTIAL INFORMATION MAY NOT BE DISCLOSED, REPRODUCED, OR USED, EITHER IN PART OR IN WHOLE, FOR THE BENEFIT OF ANY THIRD PARTY WITHOUT THE EXPRESS WRITTEN CONSENT OF PRINTEC CORPORATION.

Drn: KATE 2025/04/28

Chk: 2025/04/28

App: JOHNNY 2025/04/28

TRACKING: 031738

FILE NAME: 995-01F ART.ai

PRINTEC Printec H.T. Electronics Corp.
http://www.printecht.com
Tel:+886-2-8227899 Fax:+886-2-82275909

Title: **OVERLAY ARTWORK**

Size: D DOC. P/N: **A-0995-0001-000** Rev: **F**

Scale: free Sheet 4 of 4