

SPECIFICATION		
SUMIDA TYPE	RCH - 110	PART NO. REF. TO THE ATTACHED SHEET.

1. DIMENSION (UNIT mm)

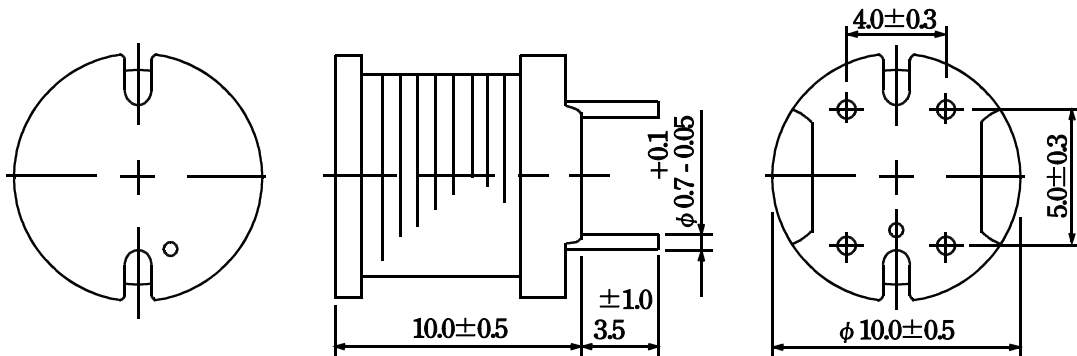

* DIMENSION DOES NOT INCLUDE SOLDER USED ON COIL.

2. CONNECTION (BOTTOM)

($10 \mu\text{H} \sim 33 \mu\text{H}$)

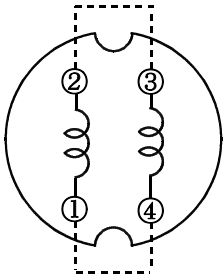

($39 \mu\text{H} \sim 1\text{mH}$)

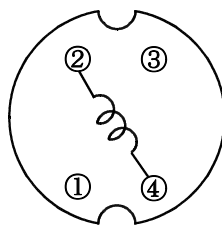

3. STAMP (Ex.)

UNFIXED THE POSITION

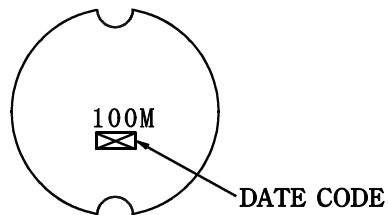

4. NOTE

* TO BE CONNECTED BETWEEN #1 AND #4, #2 AND #3 WHEN USED. ($10 \mu\text{H} \sim 33 \mu\text{H}$)

* IT IS NO MATTER FOR THE ELECTRIC CHARACTERISTICS IF TERMINAL 1 IS CONNECTED TO TERMINAL 4, TERMINAL 2 IS CONNECTED TO TERMINAL 3 WITH SOLDER. (ON THE BOTTOM OF DRUM CORE) ($10 \mu\text{H} \sim 33 \mu\text{H}$).

9th, Oct., 1997			SUMIDA CODE	0786
CHK.	CHK.	DRG.	DRG. NO. 2/4	
SUNNY	Y.J.LIU	XIA C		
			S-074-375	

T Y P E

R C H - 1 1 0

GENERAL CHARACTERISTICS

1. OPERATING TEMPERATURE : -30 ~ +100 (COIL CONTAIN HEAT)
2. EXTERNAL APPEARANCE : ON VISUAL INSPECTION. THE COIL HAS NO EXTERNAL DEFECTS.
3. TERMINAL STRENGTH : NO APPARENT AT 10N FOR 1 MINUTE. (PULL)
4. TERMINAL HEAT TEST : NO APPARENT AT 270 ± 5 FOR 5 ± 1 SECONDS.
5. INSULATING RESISTANCE : OVER 100M AT 100V D.C. BETWEEN COIL-EXTERNAL PARTS.
6. DIELECTRIC STRENGTH : NO APPARENT AT 100V D.C. FOR 1 MINUTE BETWEEN COIL-EXTERNAL PARTS.
7. INDUCTANCE TEMPERATURE COEFFICIENT : $(0 \sim 1000) \times 10^{-6} / (-25 \sim +70)$
8. HUMIDITY TEST : INDUCTANCE DEVIATION WITHIN ± 2.0 % AFTER 96 HOURS IN 90~95% RELATIVE HUMIDITY AT 40 ± 2 AND 1 HOUR DRYING UNDER NORMAL CONDITION.
9. VIBRATION TEST : INDUCTANCE DEVIATION WITHIN ± 1.0 % AFTER VIBRATION FOR 1 HOUR IN EACH OF THE THREE ORIENTATIONS AT VERTICALLY EACH OTHER (X.Y.Z) SWEEP VIBRATION (10~55~10Hz) WITH 1.5mm PP AMPLITUDE.
10. SHOCK TEST : INDUCTANCE DEVIATION WITHIN ± 1.0 % TESTED IN EACH OF THE THREE ORIENTATIONS VERTICALLY FOR 1 TIME AT THE SHOCK ACCELERATION OF $981m/s^2$ USING RUBBER BLOCK SHOCK TESTNE MACHINE.

9 t h , O c t . , 1 9 9 7

CHK .	CHK .	DRG .
SUNNY	Y.J.LIU	XIA
		C

DRG. NO.

3 / 4

S - 074 - 375

SPECIFICATION

TYPE

RCH - 110

ELECTRICAL CHARACTERISTICS

NO	PART NO. △	STAMP	INDUCTANCE [at 1kHz] <WITHIN>	D.C.R. () <MAX.> at20	RATED CURRENT (A) 1	S.R.F. (MHz) (TYP.)	MOUNTING HOLES (mm) 2	SUMIDA CODE
01	RCH110-100M	100M	10 μH ± 20%	0.022	5.3	14`	1.4	-0065
02	RCH110-120M	120M	12 μH ± 20%	0.023	4.9	11	1.4	-0076
03	RCH110-150M	150M	15 μH ± 20%	0.026	4.4	7.7	1.4	-0087
04	RCH110-180M	180M	18 μH ± 20%	0.033	4.0	7.1	1.2	-0098
05	RCH110-220M	220M	22 μH ± 20%	0.037	3.6	6.8	1.2	-0109
06	RCH110-270M	270M	27 μH ± 20%	0.048	3.3	6.1	1.2	-0110
07	RCH110-330K	330K	33 μH ± 10%	0.055	2.9	6.0	1.2	-0121
08	RCH110-390K	390K	39 μH ± 10%	0.073	2.7	8.6	1.2	-0132
09	RCH110-470K	470K	47 μH ± 10%	0.083	2.5	8.1	1.2	-0143
10	RCH110-560K	560K	56 μH ± 10%	0.092	2.3	7.6	1.2	-0154
11	RCH110-680K	680K	68 μH ± 10%	0.12	2.1	6.3	1.2	-0165
12	RCH110-820K	820K	82 μH ± 10%	0.14	1.9	6.0	1.2	-0176
13	RCH110-101K	101K	100 μH ± 10%	0.16	1.7	5.7	1.2	-0187
14	RCH110-121K	121K	120 μH ± 10%	0.20	1.5	4.8	1.2	-0198
15	RCH110-151K	151K	150 μH ± 10%	0.23	1.4	4.2	1.2	-0209
16	RCH110-181K	181K	180 μH ± 10%	0.31	1.3	3.9	1.2	-0211
17	RCH110-221K	221K	220 μH ± 10%	0.34	1.1	3.8	1.2	-0222
18	RCH110-271K	271K	270 μH ± 10%	0.40	1.0	3.4	1.2	-0233
19	RCH110-331K	331K	330 μH ± 10%	0.52	0.93	2.8	1.0	-0244
20	RCH110-391K	391K	390 μH ± 10%	0.65	0.86	2.7	1.0	-0255
21	RCH110-471K	471K	470 μH ± 10%	0.71	0.78	2.5	1.0	-0266
22	RCH110-561K	561K	560 μH ± 10%	1.0	0.71	2.2	1.0	-0277
23	RCH110-681K	681K	680 μH ± 10%	1.1	0.65	2.1	1.0	-0288
24	RCH110-821K	821K	820 μH ± 10%	1.3	0.59	2.0	1.0	-0299
25	RCH110-102K	102K	1.0 mH ± 10%	1.7	0.53	1.7	1.0	-0300

: THIS INDICATES THE VALUE OF CURRENT WHEN THE INDUCTANCE IS 10% LOWER THAN ITS INITIAL VALUE AT D.C.SUPERPOSITION OR D.C.CURRENT WHEN AT T=40 WHICHEVER IS LOWER. (Ta = 20)

2 : PLEASE GIVE SUFFICIENT CONSIDERATION TO THE THICK WIRE USED WHEN PRODUCING THE P.C.B.

9th, Oct., 1997

SUMIDA CODE

0786

CHK.	CHK.	DRG.	S - 074 - 375	DRG. NO.	4 / 4
SUNNY	Y.J.LIU	XIA C			