

1255AY-100M#

“#” at the end indicates the package specification code.

● In Production

Wire Wound Ferrite Inductor for Power Lines

1255AY-100M#

“#” at the end indicates the package specification code.



1255AY-100M=P3

Applications

| | |
|--------------------------|--|
| Unsuitable Applications | Please be sure to read and comply with these " <u>Precautions for use</u> ". |
| Specific Applications | <u>Consumer equipment, Industrial equipment except for transportation & facility & energy equipment, Medical equipment [GHTF A/B/C] except for implant & surgery & auto injector</u> Please refer to Our Website and specifications, etc. for information about the performance, functions, quality, management, and safety required for the above applications, and use Products after confirming the performance and reliability of the actual Product. |
| Recommended Applications | Consumer equipment |

Attention

1. This datasheet is downloaded from the website of Murata Manufacturing Co., Ltd. Therefore, it's specifications are subject to change or our products in it may be discontinued without advance notice. Please check with our sales representatives or product engineers before ordering.
2. This datasheet has only typical specifications because there is no space for detailed specifications.
 Therefore, please review our product specifications or consult the approval sheet for product specifications before ordering.

1255AY-100M#

“#”at the end indicates the package specification code.

Appearance & Shape

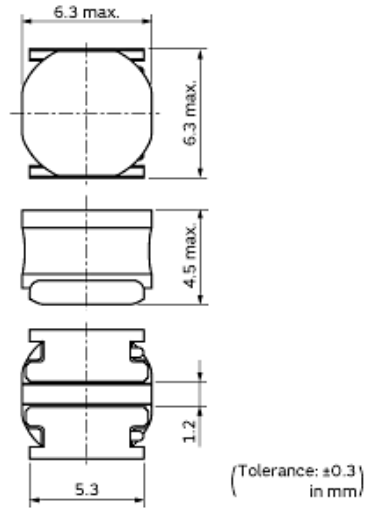

| | |
|-----------------------|------------|
| Length | 6mm ±0.3mm |
| Width | 6mm ±0.3mm |
| Thickness | 4.5mm |
| Size code in mm(inch) | 6060/2424 |

Attention

1. This datasheet is downloaded from the website of Murata Manufacturing Co., Ltd. Therefore, it's specifications are subject to change or our products in it may be discontinued without advance notice. Please check with our sales representatives or product engineers before ordering.
2. This datasheet has only typical specifications because there is no space for detailed specifications. Therefore, please review our product specifications or consult the approval sheet for product specifications before ordering.

1255AY-100M#

“#”at the end indicates the package specification code.

Specifications

| | |
|---|---------------------------|
| Inductance | 10μH ±20% |
| Inductance Test Frequency | 0.1MHz |
| Rated Current (Temperature Rise) / Max. | 2.9A |
| Rated Current (Temperature Rise) / Typ. | 3.6A |
| Rated Current (L Change) / Max. | 3.1A |
| Rated Current (L Change) / Typ. | 4.1A |
| DC Resistance(max.) | 0.0564Ω |
| DC Resistance | 0.047Ω ±20% |
| Operating Temperature | -40 ~ 85°C |
| Type of magnetic shield | Shielded (Magnetic Resin) |
| Series | DG6045C |
| Brand | Murata |
| Soldering Support | Reflow soldering |

Attention

1. This datasheet is downloaded from the website of Murata Manufacturing Co., Ltd. Therefore, it's specifications are subject to change or our products in it may be discontinued without advance notice. Please check with our sales representatives or product engineers before ordering.
2. This datasheet has only typical specifications because there is no space for detailed specifications.
 Therefore, please review our product specifications or consult the approval sheet for product specifications before ordering.

1255AY-100M#

“#”at the end indicates the package specification code.

Notices

Rated current (Isat) is specified when the decrease of the initial inductance value at 30%.
Rated current (Itemp) is specified when temperature of the inductor is raised 40°C by DC current.

References

| Packaging | Specifications  | Standard Packing Quantity |
|-----------|--|---------------------------|
| =P3 | 330Embossed Tape | 1500 |

| Mass(Typ.) | |
|------------|--------|
| 1 piece | 0.562g |

Attention

1. This datasheet is downloaded from the website of Murata Manufacturing Co., Ltd. Therefore, it's specifications are subject to change or our products in it may be discontinued without advance notice. Please check with our sales representatives or product engineers before ordering.
2. This datasheet has only typical specifications because there is no space for detailed specifications.
Therefore, please review our product specifications or consult the approval sheet for product specifications before ordering.

1255AY-100M#

“#” at the end indicates the package specification code.

Basic

L-Current

Temp.rise

Attention

1. This datasheet is downloaded from the website of Murata Manufacturing Co., Ltd. Therefore, it's specifications are subject to change or our products in it may be discontinued without advance notice. Please check with our sales representatives or product engineers before ordering.
2. This datasheet has only typical specifications because there is no space for detailed specifications.
Therefore, please review our product specifications or consult the approval sheet for product specifications before ordering.

1255AY-100M#

“#”at the end indicates the package specification code.

Frequency Characteristic

L

Q

|Z|

Attention

1. This datasheet is downloaded from the website of Murata Manufacturing Co., Ltd. Therefore, it's specifications are subject to change or our products in it may be discontinued without advance notice. Please check with our sales representatives or product engineers before ordering.
2. This datasheet has only typical specifications because there is no space for detailed specifications.
Therefore, please review our product specifications or consult the approval sheet for product specifications before ordering.

1255AY-100M#

“#” at the end indicates the package specification code.

Product Data

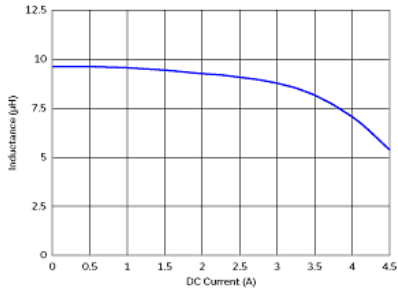

Impedance - Current Characteristics

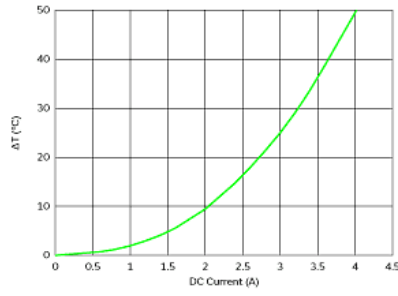

Temperature Increase Characteristic

Attention

1. This datasheet is downloaded from the website of Murata Manufacturing Co., Ltd. Therefore, its specifications are subject to change or our products in it may be discontinued without advance notice. Please check with our sales representatives or product engineers before ordering.
2. This datasheet has only typical specifications because there is no space for detailed specifications.
Therefore, please review our product specifications or consult the approval sheet for product specifications before ordering.